

GT900

4CH FHD,HD,HD,HD DASH CAM



Quick Guide rev01

This manual covers only the most basic contents for using GT900. For details about GT900, please check the contents on the web site (<http://www.gnetsystem.com>).

Equipment name: Car accident video recorder (GT900) | Year of manufacture: listed in product box
Manufacturer / Country of Origin: GNET SYSTEM CO., LTD./ Korea | Certification Number: R-R-TLP-GT900

Scope of warranty and liability

1. Typical memory storage devices have a usable life, and data may be lost due to storage life and static or external voltage shocks. Be sure to copy important storage data to another storage device
2. Except for damage caused by the failure of this product or loss of stored data, our company shall not be liable for any damages.

※ Manuals and specifications are subject to change without notice to improve quality.

Micro SD Memory Precautions

- Micro SD memory is a consumable product with a read/write life due to its nature. Regular management is required as the recording may not be possible during prolonged use (Please note that we will not be liable for recording errors due to out-of-lifespan memory.)
- Third-party Micro SD memory purchases may cause compatibility issues with the product, so please purchase our memory. Memory not provided by us will be excluded from A/S
- In the event of a car accident, take out the Micro SD memory and store the recorded video on your computer. The recorded images will be overwritten sequentially by regular recording, etc. and the accident images will be erased.
- Be sure to turn off the product power and then disconnect the Micro SD memory after verifying that the REC LED is off. If not so, recorded images may be damaged, Micro SD memory may be defective or live shorter.
- If there is any data other than GT900-only program and recorded video provided in Micro SD memory, it is automatically deleted to improve stability. [Do not use the memory card you are using in the dash cam for any other purpose. It will be automatically deleted when inserted to the product]
- It is possible to use it without errors even if memory is not formatted with its own JDR file system, but it is recommended to format it more than once a month because there may be a hardware error.
 - Please download the SD Formatter program through <http://www.sdcard.org> and check if there is any abnormality in Micro SD memory.
- Micro SD memory cards used in this product are recommended for the dedicated memory cards of GNET. Memory cards other than the dedicated memory card of GNET may not operate properly. Micro SD memory can support 1TB and SSD external storage can support maximum 1TB(Specification:M,2 SATA3, Interface key:B Key, B+M Compatible, Max. Storage capacity : 2280 supported)
- If you install Micro SD memory for the first time or after formatting, it takes about 3 ~ 5 minutes for micro SD memory check and data generation depending on the capacity of Micro SD memory. Do not turn off the power or remove Micro SD memory during operation. – If Micro SD memory is removed during data generation, it may not be recorded.

Precautions for safe use

All rights to the product are in GNET and are protected under copyright law. Unauthorized copying, modification and distribution without prior consent of GNET may be subject to criminal penalties.

- Do not expose the unit to excessive shocks or debris. (This may damage the product or cause fire and electric shock.)
- Avoid excessive tanning or special glass as much as possible. (The images could be blurry or distorted and it may cause a problem to GPS reception rate.)
- Do not disconnect or modify the product at your discretion. (We are not responsible for any damage caused by user tampering.)
- While driving, please refrain from checking or operating the product for safety.
- When cleaning the inside of vehicle, do not use water or volatile chemicals to clean the product. (This may damage the product or cause fire and electric shock.)
- If it is not used for a long period of time, the time of the product may be reset. Please always check the time. (Excluded when connecting external GPS)
- When exposed to direct sunlight for a long period of time, recognition error of SD card and camera image distortion may occur due to temperature increase inside vehicle. If outdoor parking is required for a long period of time, disconnecting power may help to use your dash cam without any problems
- Avoid high temperature or high humidity environment for normal operation of the product.
- Please periodically check if the equipment operates normally.
- Check the operation of the internal camera periodically on the LCD real-time screen before driving. If the internal camera is defective, the screen is not switched to the internal image and only the front image is captured.
- If the camera cables are artificially extended or cut, the quality of the product may be affected.

Product specification



Smartphone connection

How to connect a smartphone – Android

1 After installing Gnet app, run it on the smartphone screen

2 Touch Wi-Fi button of the dash cam, You can hear a voice message "Registration standby mode".

The registration standby mode keeps for 2 minutes. When the time elapsed, the voice guidance "Registration standby mode is canceled" will come out.

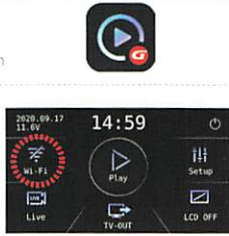

3 Touch "Device registration" button in the center of the mobile APP screen.

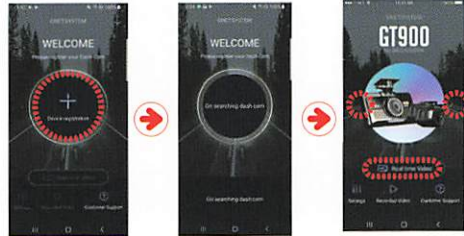

When Wi-Fi search is complete, select any dash cam that you want by using the left and right arrows and then click the button "Connecting Device".

4 The registration of the dash cam is completed. Enter the information and touch 'Save' button

The information input is for the purpose of classification when using many dash cams.

If the connection fails

Please go to "Customer Support" section at the bottom of the mobile app screen for help with connection. If you still have difficulty connecting, you can contact us via the Customer Center.



APP Main Screen Description



- 1 This function allows you to connect other dash cams or delete the registered devices.
※ Supported only on Android mobile
- 2 Real-Time Video
You can watch a real-time video.
- 3 Settings
You can easily change settings via your smartphone. After changing the settings, press "Save" button to reboot the product (dash cam)
- 4 Recorded Video
You can see a recorded video of the dash cam. The video that you need can be saved to the mobile device via download.
- 5 Customer Support
You can get help with connection via customer support on app or you can get help by calling our customer support center.

App screen description for a recorded video



Both vertical and horizontal modes are provided to the screen of real-time and recorded videos, allowing you to view the images in a wider screen depending on the situation.

! While playback, it is not recorded to stabilize the product. Recording automatically starts, when you switch from playback mode to live mode.

How to connect your smartphone – iOS

1 After installing Gnet app, run it on the smartphone screen

2 Touch Wi-Fi button of the dash cam, You can hear a voice message "Registration standby mode"

The registration standby mode keeps for 2 minutes. When the time elapsed, the voice guidance "Registration standby mode is canceled" will come out.



3 Turn on Wi-Fi in the Settings menu on your smartphone.

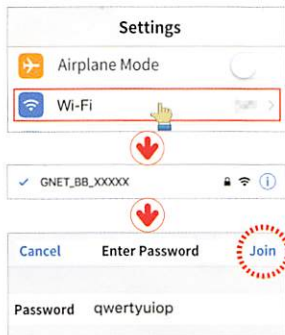

4 In the Wi-Fi list, select a name that starts with GNET_BB_.

5 Enter [qwertyuiop] in the password field and click "Connecting" button.

6 The connection to the dash cam is complete and Gnet app is available.



If the connection fails

Please go to "Customer Support" section at the bottom of the mobile app screen for help with connection.



Warranty Card

Product	GNET Dash cam		Model	GT900
Serial Number			Purchasing date	
Consumer	Name	Tel		
	Address			
※ GNET provides a 1-year warranty and GNET provides a 3-month guarantee for SD card.				



HO: 6F, Lotte IT Castle 2-Dong, Gasan Digital 2-9B, Geumcheon-gu, Seoul, Korea, 08506
 Factory: Songsan-ro 514-5 Songsan-myun, Hwasung-si, Gyunggi-Do, Korea
 Tel: +82 2 890-1728
 E-mail: info@gnetssystem.com
 Website: www.gnetssystem.com/en

