

**App Note 1102: SKS906 Sprinter Alarm Connection**

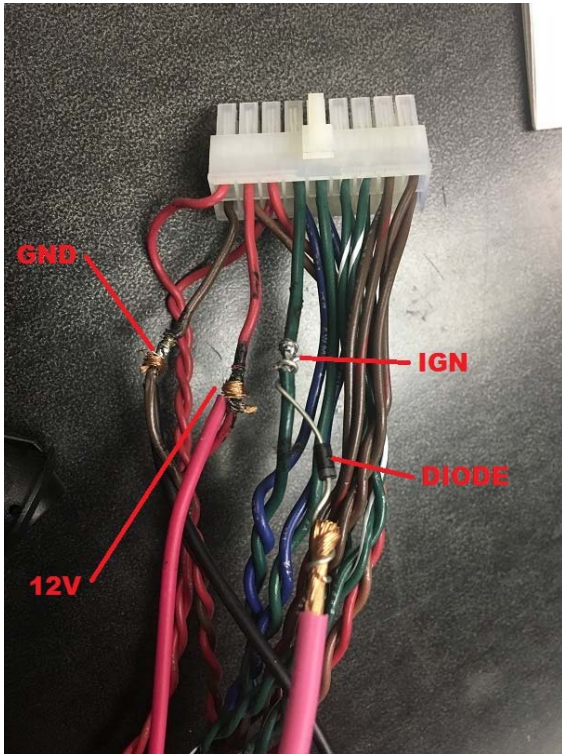

**Directed Remote Start Connection**

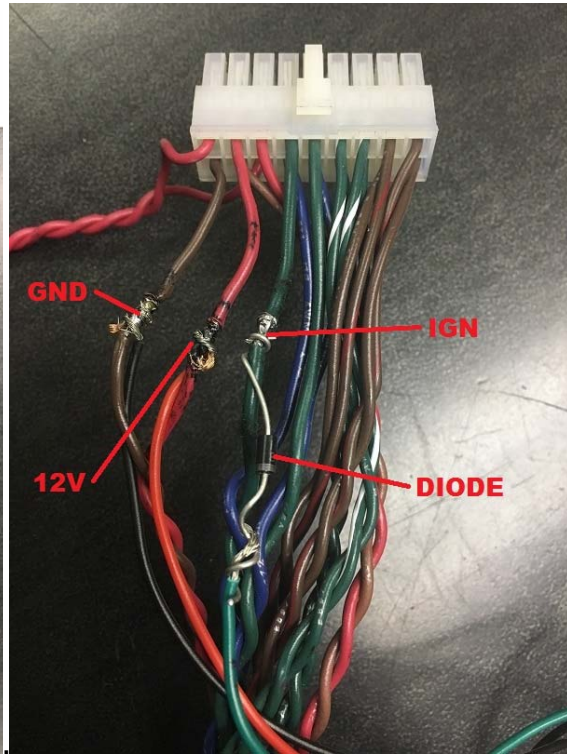

**Compustar Remote Start Connection**

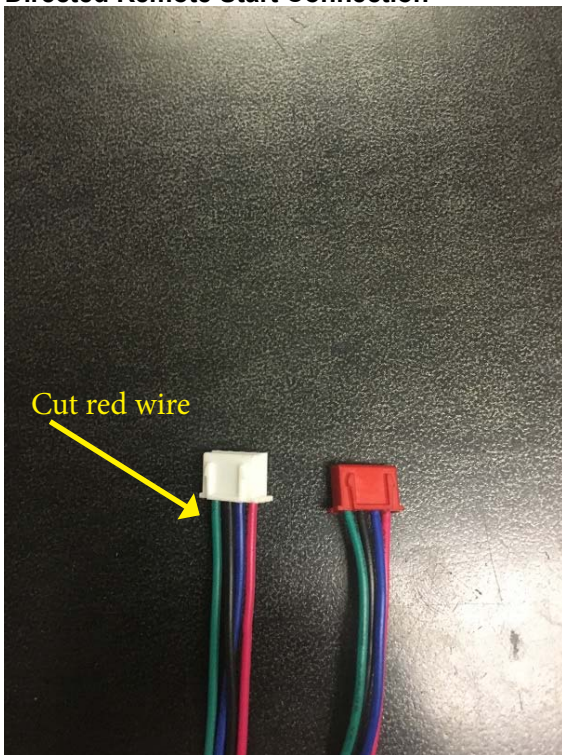

**Directed Data Cable (straight through)**

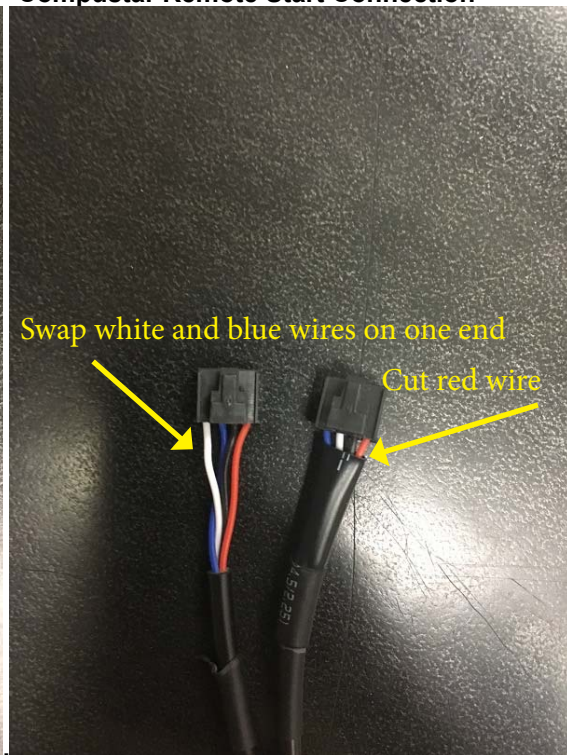

**Compustar Data Cable (pin 1,2 are crossed)**

**NOTE: CUT RED WIRE ON RS232 / D2D CABLE**